

NOTES:

1. PART TO BE SYMMETRICAL ABOUT CENTERLINE TO WITHIN .004 T.I.R.
2. FOR ACTUATOR MOUNTING DIMENSIONS SEE ES021697.
3. PACKING CARTONS CONTAINING THESE PARTS ARE TO BE MARKED WITH PART NUMBER AND CURRENT REVISION LEVEL.
4. MATERIAL TO BE .018+/- .001 HALF HARD STAINLESS STEEL PER MASTER SPECIFICATION 0073-0000.
5. FOR ACTUATOR ITEM DESCRIPTION SEE ES019953.
6. PARTS ARE SHEARED SECONDARY AND FOLLOW DEPARTMENT 20 DISTRIBUTION.
7. THIS ACTUATORS DESIGN INTENT IS TO SUPPLY CUSTOMERS THAT PREVIOUSLY PURCHASED DA SWITCHES WITH AN EQUIVALENT OPERATING POSITION ON THE DB SWITCHES. FOR STANDARD DB ACTUATOR MOUNTING SEE ES020377.

8. [H] INDICATES ITEMS THAT MUST BE CHECKED AND RECORDED ON A HISTORY CARD.

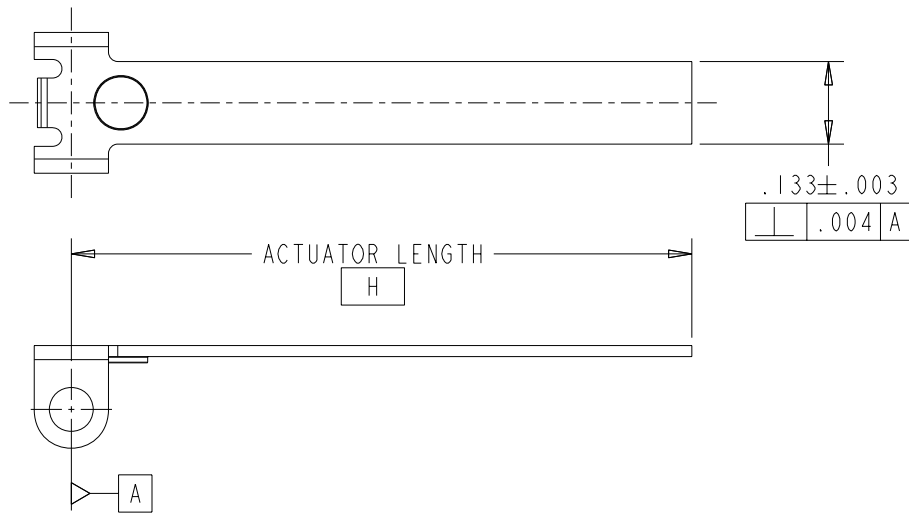

D		6				
PART NUMBER	REV	ACTUATOR LENGTH	DIE NUMBER	MATERIAL NUMBER	SECONDARY SHEARED ACTUATOR	OLD DA ACTUATOR
00147281	A	0.762	00850798	00730167		00145576
00147282	A	2.163	00850182	00730173		00145582
00147283	A	3.066	00850182	00730163		00145519
00147285	A	0.689	00850798	00730238		00146439
00147286	A	0.894	00850812	00730169		00145577
00147288	A	0.645	00850798	00730168		00145575
00147289	A	1.051	00850812	00730171		00145580
00147292	A	1.179	00850812	00730166		00145842
00147296	A	0.740	00850812	00730191		00145937
00147298	A	1.397	00850812			00146039
00147313	A	1.791			00147283	00147153
00147321	A	0.831			00147283	00146220

D	17518	17-Jul-08	HV	RY
REV	ECO NO.	DATE	PREP	APVD

DWN: TLM	THE CONFIDENTIAL AND PROPRIETARY INFORMATION CONTAINED IN THIS DOCUMENT IS OWNED BY CHERRY ELECTRICAL PRODUCTS, A DIVISION OF THE CHERRY CORPORATION WHO MUST GIVE WRITTEN PERMISSION BEFORE THE DOCUMENT OR INFORMATION CAN BE COPIED, DISCLOSED OR USED IN ANY WAY.	11200 88TH AVE. PLEASANT PRAIRIE, WI 53158 ELECTRICAL PRODUCTS
APVD: RC		
DATE: 12-Jan-07		
THIRD ANGLE PROJECTION	TOLERANCE UNLESS SPECIFIED DWG UNITS X.XX X.XXX ANGLES INCHES ± 0.01 ± 0.005 ± 2.0°	NAME / DESCRIPTION ACTUATOR
PROJECT / CSR 06-0545A		B ITEM NO. 00147280 SCALE: 5:1 SH 1 OF 1

ORIGINAL ON PROJE