

**200 V - 1,000 V Rectifiers**  
**15.0 A Forward Current**  
**70 ns - 3000 ns Recovery Time**

**Z02UL - Z10UL**  
**Z02FL - Z10FL**  
**Z02SL - Z10SL**

**SURFACE MOUNT**  
**HERMETICALLY SEALED**



**ELECTRICAL CHARACTERISTICS AND MAXIMUM RATINGS**

Part Number	Working Reverse Voltage (V <sub>rw</sub> )	Average Rectified Current (I <sub>o</sub> )		Reverse Current @ V <sub>rw</sub> (I <sub>r</sub> )		Forward Voltage (V <sub>f</sub> )		1 Cycle Surge Current t <sub>p</sub> =8.3ms (I <sub>fsm</sub> )	Repetitive Surge Current (I <sub>frm</sub> )	Reverse Recovery Time (3) (T <sub>rr</sub> )	Thermal Impd. θ <sub>J-C</sub>	Junction Cap. @50VDC @1kHz (C <sub>j</sub> )
		55°C(1)	100°C(2)	25°C	100°C	25°C	25°C	25°C	25°C	25°C	25°C	25°C
	Volts	Amps	Amps	µA	µA	Volts	Amps	Amps	Amps	ns	°C/ W	pF
Z02UL Z06UL Z10UL	200 600 1000	15.0 15.0 15.0	10.0 10.0 10.0	1.0 1.0 1.0	25 25 25	1.7 1.7 2.1	9.0 9.0 9.0	100 100 100	25 25 25	70 70 70	3 3 3	35 35 35
Z02FL Z06FL Z10FL	200 600 1000	15.0 15.0 15.0	10.0 10.0 10.0	1.0 1.0 1.0	25 25 25	1.5 1.5 1.8	9.0 9.0 9.0	100 100 100	25 25 25	150 150 150	3 3 3	35 35 35
Z02SL Z06SL Z10SL	200 600 1000	15.0 15.0 15.0	10.0 10.0 10.0	1.0 1.0 1.0	25 25 25	1.1 1.1 1.2	9.0 9.0 9.0	150 150 150	25 25 25	3000 3000 3000	3 3 3	35 35 35

(1)TC=55°C (2)TC=100°C (3)I<sub>f</sub>=0.5A, I<sub>r</sub>=1.0A, I<sub>rr</sub>=0.25A \*Op. Temp.= -65°C to +175°C Stg. Temp.= -65°C to +200°C

Markings:  
 Three Dots for polarity.

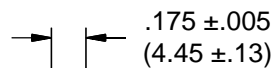
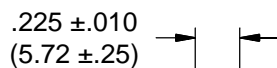

.031  
 Dimension uncontrolled  
 in this area due to  
 solder fillet.

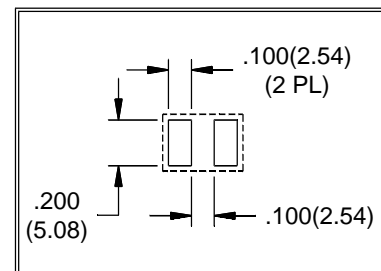
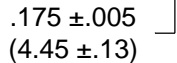

Dimensions: In. (mm) • All temperatures are ambient unless otherwise noted. • Data subject to change without notice.



**VOLTAGE MULTIPLIERS INC.**  
 8711 W. Roosevelt Ave.  
 Visalia, CA 93291

TEL 559-651-1402  
 FAX 559-651-0740  
 www.voltagemultipliers.com

**6**

# Z02UL - Z10UL • Z02FL - Z10FL • Z02SL - Z10SL

